

ACZRT55C5V1-G Thru. ACZRT55C18-G

RoHS Device
Halogen Free

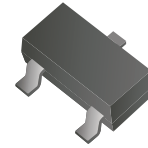

Features

- Planar Die Construction.
- Ideally Suited For Automated Assembly Processes.
- Comply with AEC-Q101

Mechanical data

- Case: Molded plastic, SOT-23
- Mounting position: Any

Circuit diagram

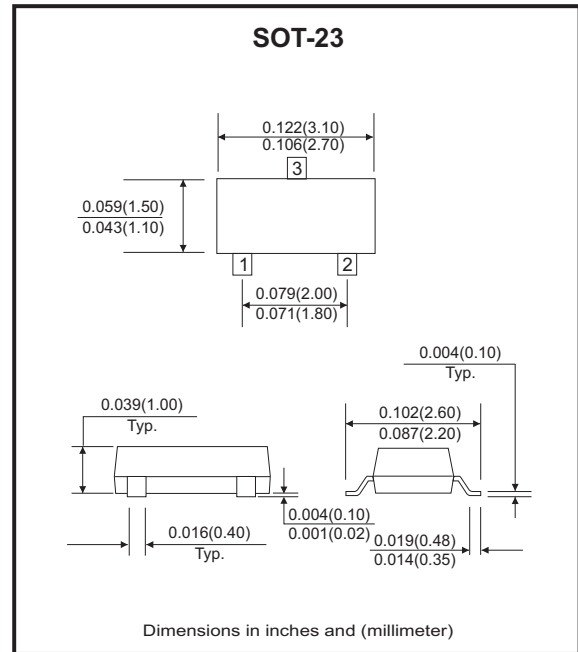
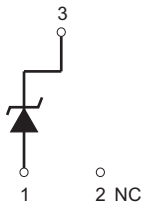

Maximum Ratings (T_A=25°C unless otherwise noted)

Parameter	Symbol	Value	Unit
Forward voltage at I _F =10mA	V _F	0.9	V
Power dissipation	P _D	350	mW
Thermal resistance, junction to ambient air	R _{θJA}	500	°C/W
Junction temperature range	T _J	-55 to +150	°C
Storage temperature range	T _{STG}	-65 to +150	°C

Note: 1. Valid provided that device terminals are kept at ambient temperature.
 2. Tested with pulses, 300µs pulse width, period = 5ms.
 3. f = 1KHz.

Electrical Characteristics (T_A=25°C unless otherwise noted)

Part Number	Zener Voltage			Maximum Zener Impedance			Maximum Reverse Current		Typ. Temp. Coefficient		Marking Code	
	V _{ZT}			@ I _{ZT}	Z _{ZT} @ I _{ZT}	Z _{ZK}	@ I _{ZK}	I _R @ V _R		@ I _{ZT} mV/°C		
	Nom(V)	Min(V)	Max(V)	(mA)	(Ω)	(Ω)	(mA)	(μA)	(V)	Min.		Max.
ACZRT55C5V1-G	5.1	4.8	5.4	5.0	60	480	1.0	2.0	2.0	-2.7	1.2	Z2
ACZRT55C15-G	15	13.8	15.6	5.0	30	200	1.0	0.1	10.5	9.2	13.0	Y4
ACZRT55C18-G	18	16.8	19.1	5.0	45	225	1.0	0.1	12.6	12.4	16.0	Y6

Rating and Characteristic Curves (ACZRT55C-G Series)

Fig.1 - Power Derating Curve

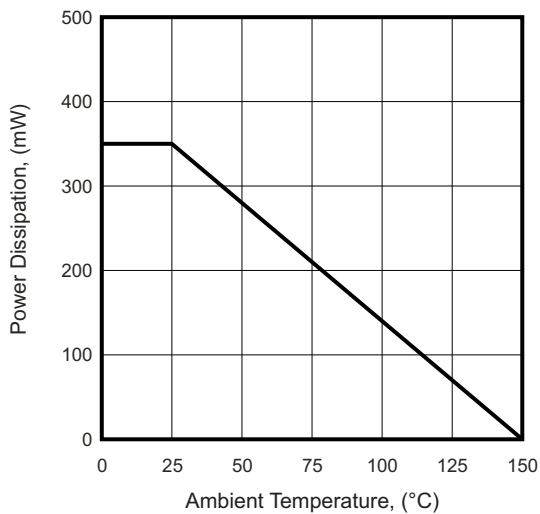
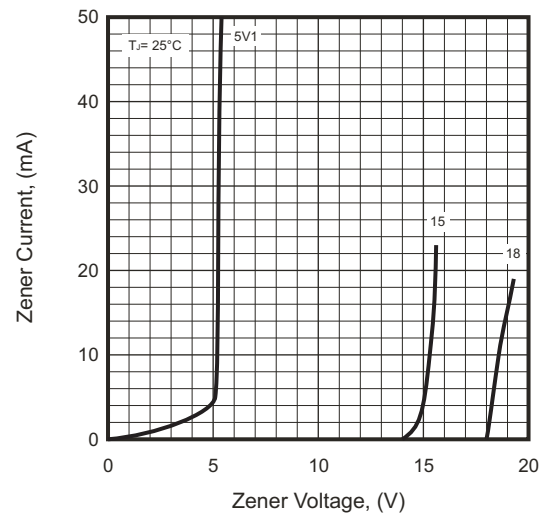
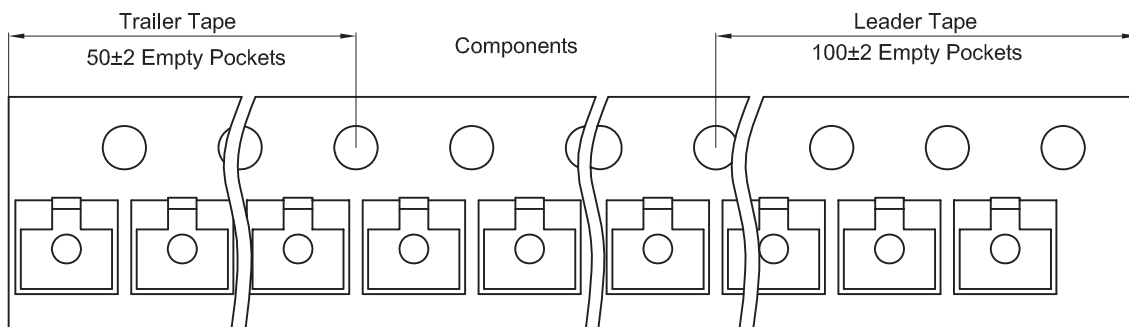
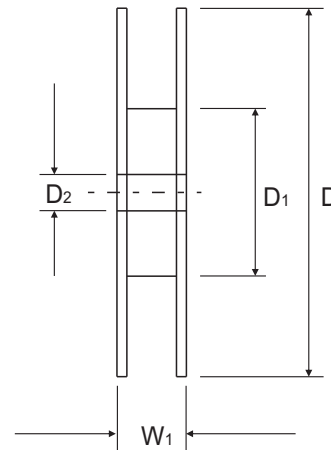
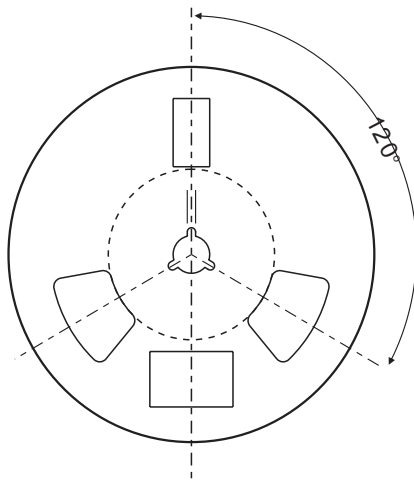
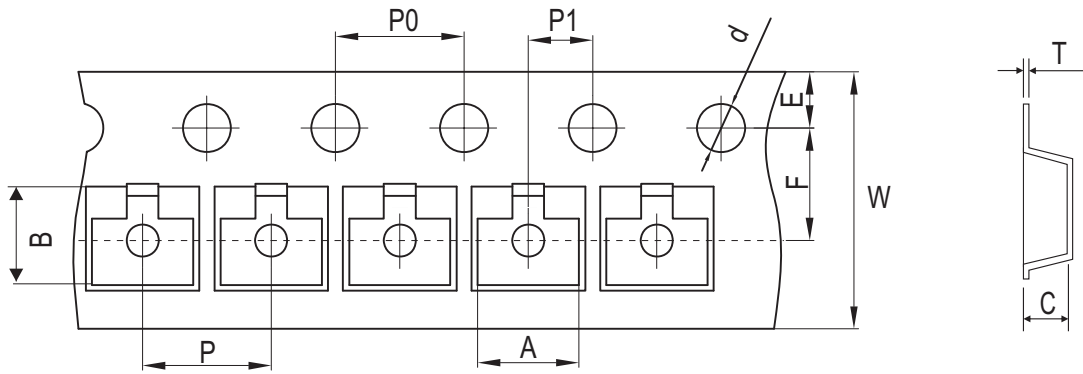

Fig.2 - Zener Breakdown Characteristics



Reel Taping Specification



SOT-23	SYMBOL	A	B	C	d	D	D1	D2
	(mm)	3.15 ± 0.10	2.77 ± 0.10	1.22 ± 0.10	1.50 + 0.10	178.00 ± 1.00	54.00 ± 0.50	13.00 ± 0.50
	(inch)	0.124 ± 0.004	0.109 ± 0.004	0.048 ± 0.004	0.059 + 0.004	7.008 ± 0.039	2.126 ± 0.020	0.512 ± 0.020

SOT-23	SYMBOL	E	F	P	P0	P1	W	W1
	(mm)	1.75 ± 0.10	3.50 ± 0.05	4.00 ± 0.10	4.00 ± 0.10	2.00 ± 0.05	8.00 + 0.30 / - 0.10	9.50 ± 1.00
	(inch)	0.069 ± 0.004	0.138 ± 0.002	0.158 ± 0.004	0.158 ± 0.004	0.079 ± 0.002	0.315 + 0.012 / - 0.004	0.374 ± 0.039

Company reserves the right to improve product design, functions and reliability without notice.

REV: A

Marking Code

Part Number	Marking Code
ACZRT55C5V1-G	Z2
ACZRT55C15-G	Y4
ACZRT55C18-G	Y6

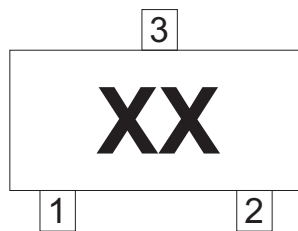

xx = Product type marking code

Suggested PAD Layout

SIZE	SOT-23	
	(mm)	(inch)
A	0.90	0.035
B	0.80	0.031
C	1.90	0.075
D	2.00	0.079

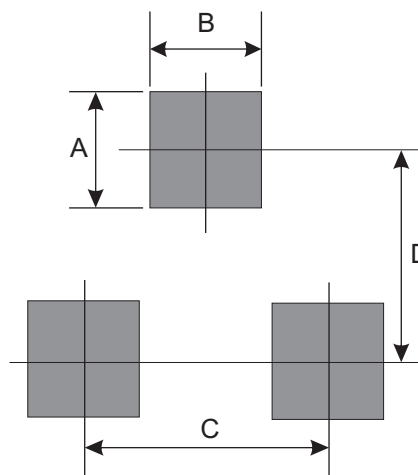

Note:

1. The pad layout is for reference purposes only.

Standard Packaging

Case Type	REEL PACK	
	REEL (pcs)	Reel Size (inch)
SOT-23	3,000	7